

Detail "A"

Technical drawing of the 1000 series camera. The top view shows a square body with a central lens assembly. Dimensions are indicated: a width of 109 mm and a height of 59 mm for the top section. The front view shows the camera mounted on a base with a lens and a viewfinder.

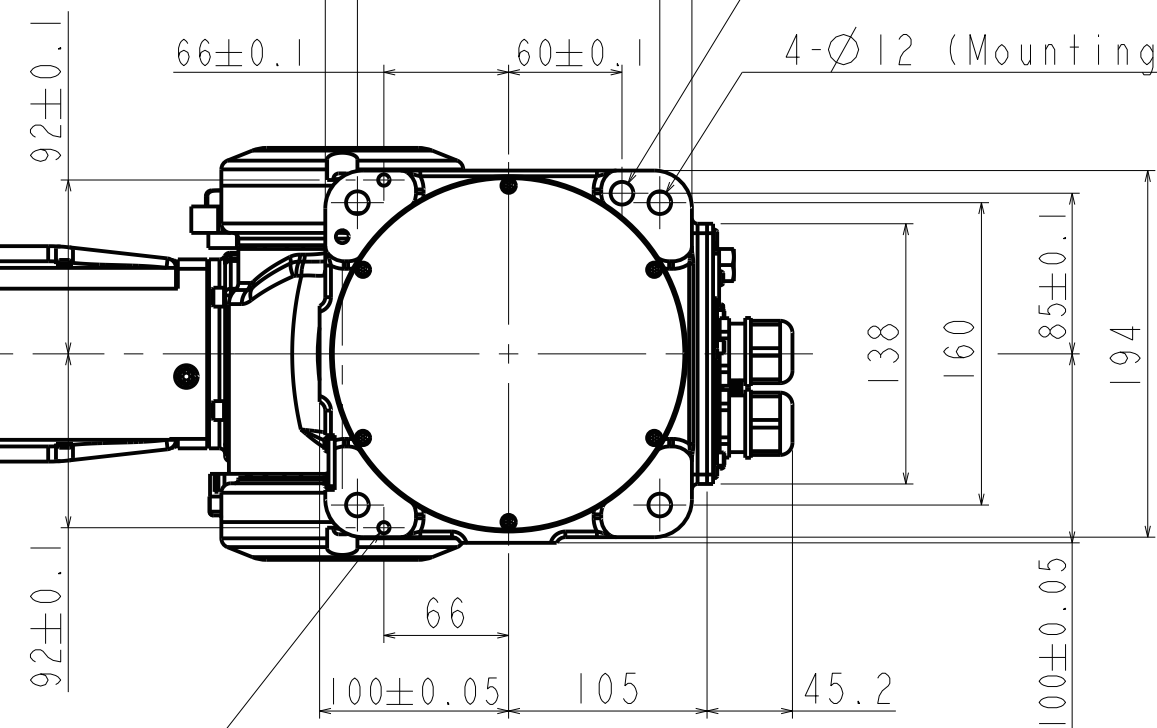
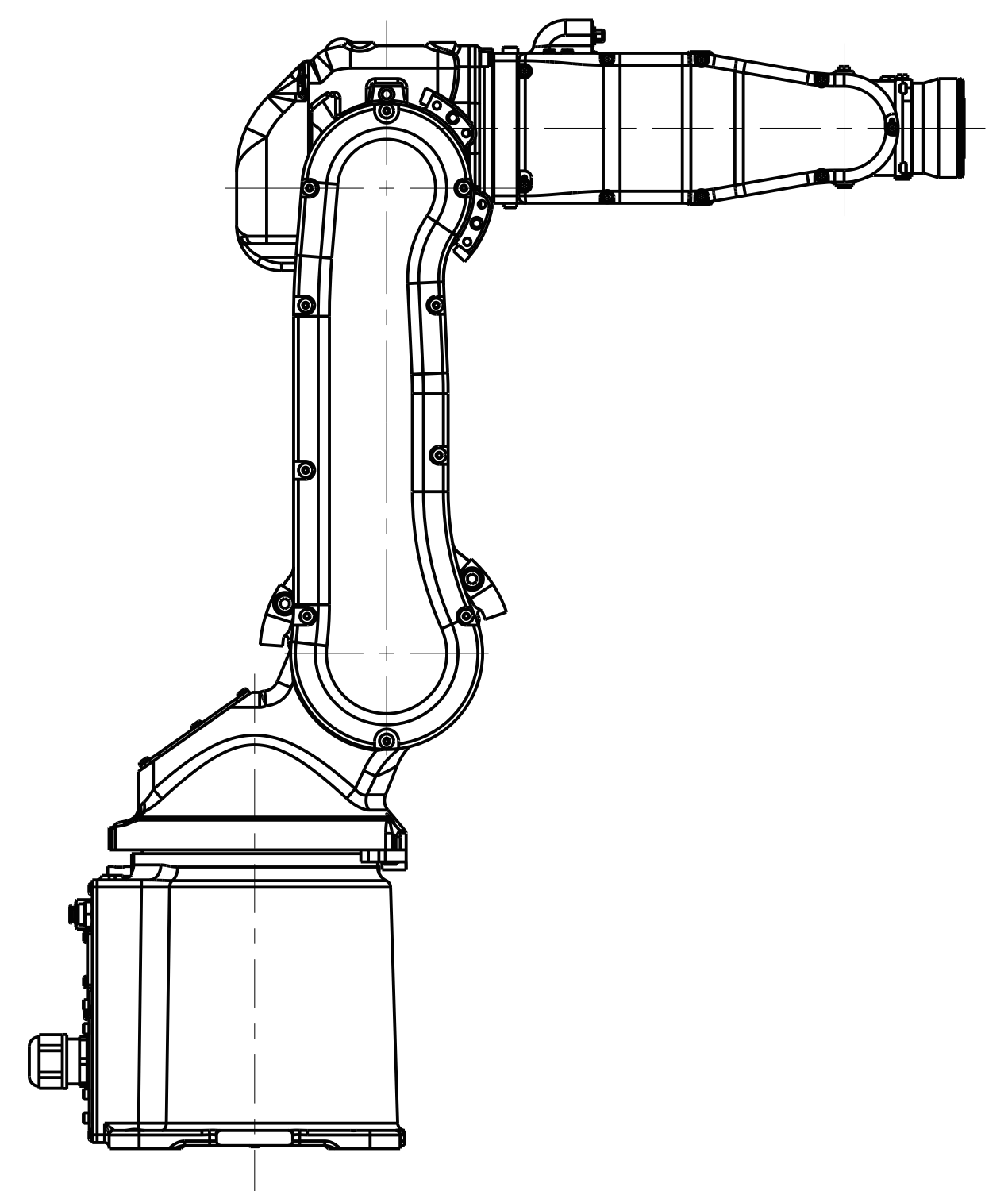
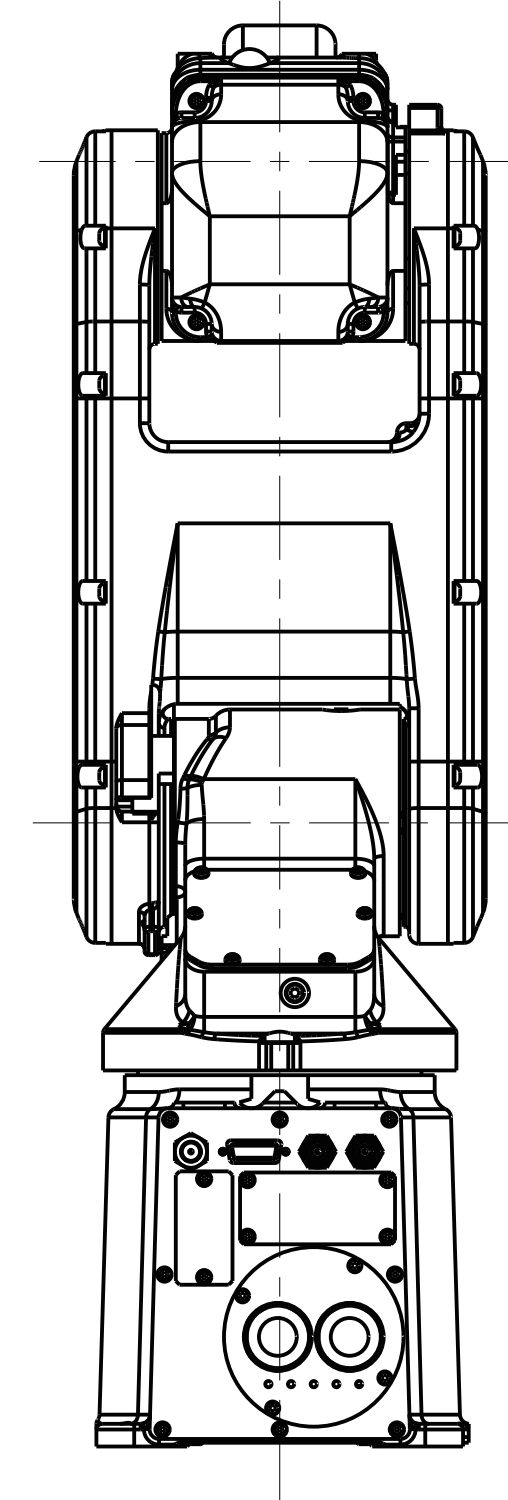
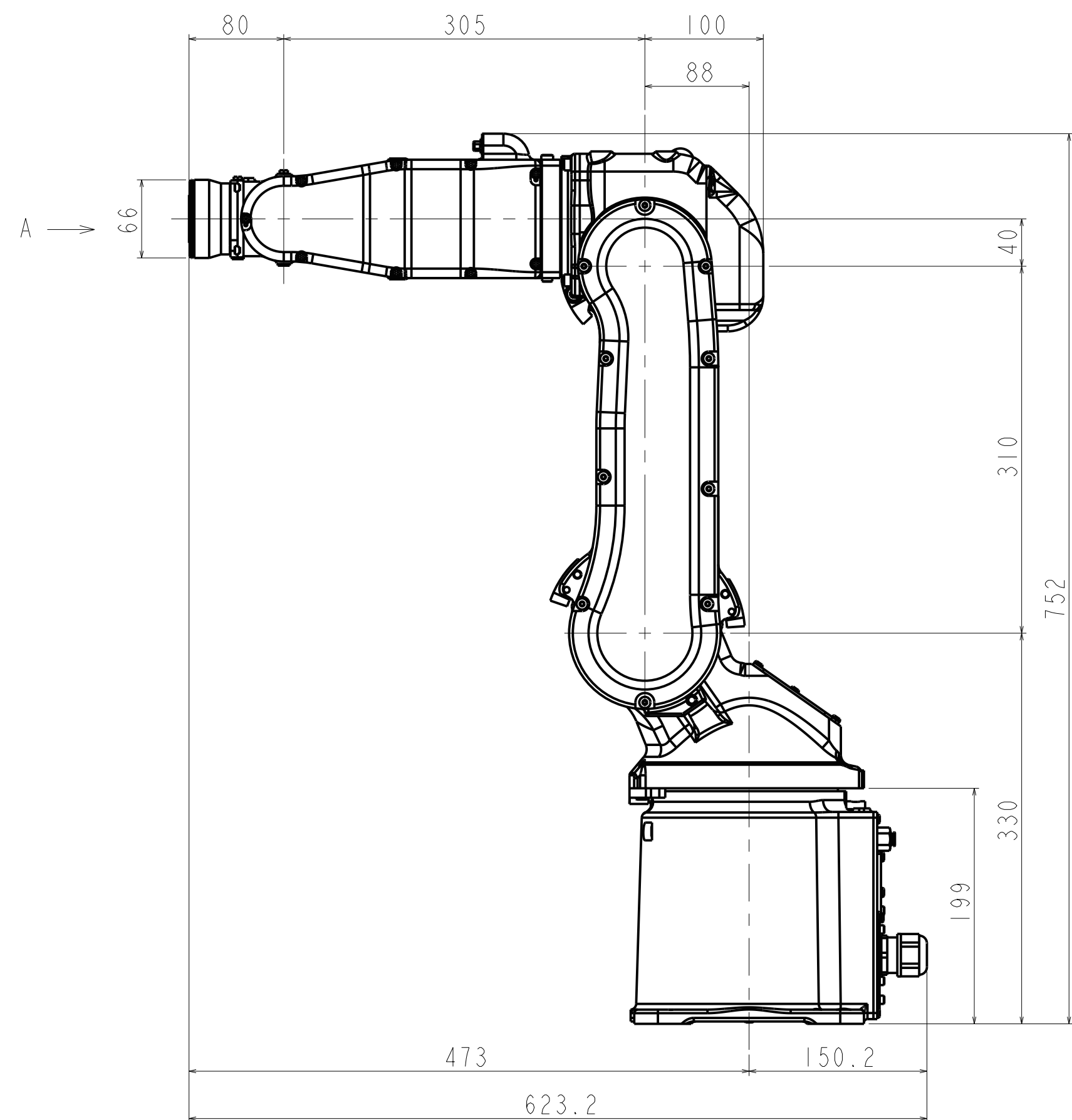

				TITLE	S5-A70IS External dimensions
			DRW.No.		REV.No.
SEIKO EPSON CORP.					S5-A70IS